

PRINCE GEORGE COUNTY
DEPARTMENT OF PUBLIC UTILITIES

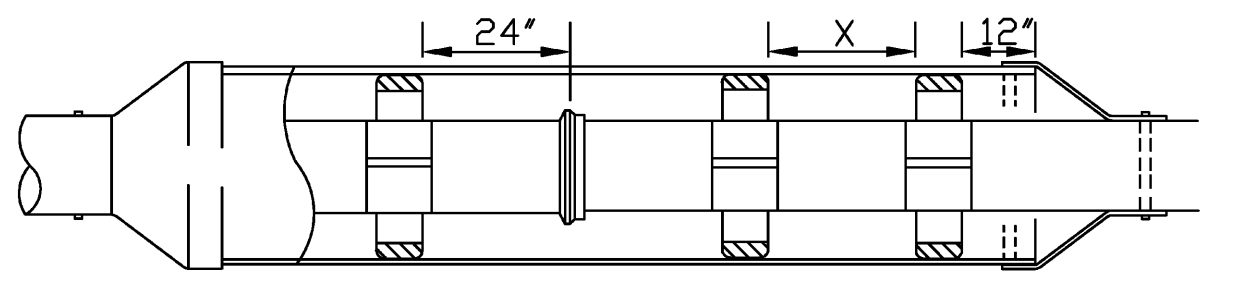

- CASING DETAIL NOTES:**
- CARRIER PIPE SHALL BE CENTERED WITHIN CASING BY AN APPROVED STAINLESS STEEL CASING SPACER.
 - CASING PIPE SHALL BE SEALED BY USE OF WRAPAROUND END SEALS OR WRAP ENDS OF CARRIER PIPE WITH TAR PAPER AND INSTALL 4" THICK BRICK AND MORTAR PLUG IN THE ANNULAR SPACE A 1" WEEP HOLE.
 - THREE CASING SPACERS SHALL BE ATTACHED TO EACH JOINT OF CARRIER PIPE WITH ONE AT THE CENTER AND ONE NOT MORE THAN 24" FROM EACH END.
 - ONE CASING SPACER SHALL BE LOCATED NOT MORE THAN 12" FROM EACH END OF CASING PIPE.
 - VALVES OR OTHER CONTROL/MAINTENANCE EQUIPMENT ATTACHED TO WATERLINE/SEWER FORCE MAINS SHALL BE LOCATED A MINIMUM FOUR PIPE LENGTHS FROM THE END OF THE CASING, OR AS APPROVED BY THE COUNTY.
 - STEEL CASING SHALL HAVE A MINIMUM YIELD STRENGTH OF 35,000 PSI AND SUFFICIENT CORROSION PROTECTION.
 - LINE TO BE ENCASED UNDER STATE ROADS/RAILROADS WILL COMPLY WITH COUNTY AND ANY APPLICABLE VDOT/AMERICAN RAILROAD ENGINEERING SPECIFICATIONS WHICHEVER IS MORE STRINGENT.
 - WHEN INSTALLING CARRIER PIPE, CONTRACTOR SHALL PUSH SO THAT PIPE JOINTS ARE ALWAYS BEING COMPRESSED.
 - REINFORCED CONCRETE CASING PIPE SHALL BE ASTM C-76, CLASS III STEEL CASING PIPE SHALL BE ASTM-139, GRADE B.
 - ALL WATERLINES IN CASING SHALL BE A MINIMUM CLASS 52 DUCTILE IRON WITH M.J. BELLS AND AN APPROVED JOINT RESTRAINT DEVICE AT EACH M.J. CONNECTION. MINIMUM 3 JOINTS OUTSIDE EACH END OF CASING SHALL BE M.J. DUCTILE IRON WITH RESTRAINED JOINTS.

DATE JAN. 2008	CASING DETAIL FOR WATER LINES & SEWER FORCE MAINS	DRWG. NO. CAS-4
REVISIONS		

THIS DRAWING PREPARED AT THE
TRI-CITIES OFFICE
4250 Crossings Blvd. | Prince Georges, Va. 23875
TEL 804-436-6660 FAX 804-731-0736 www.timmons.com

YOUR VISION ACHIEVED THROUGH OURS.

DATE	REVISION DESCRIPTION	DATE	REVISION DESCRIPTION
10/16/09	VDOT COMMENTS		
11/13/09	VDOT COMMENTS		
12/23/09	VDOT COMMENTS		
11/25/13	COUNTY COMMENTS		

16 JULY 2009

DRAWN BY
K. HALPAUS

DESIGNED BY
K. HALPAUS

CHECKED BY
D. JOHNSON

SCALE
H: 1"=50'
V: 1"=5'

TIMMONS GROUP

PRINCE GEORGE COUNTY DEPARTMENT OF PUBLIC UTILITIES

PUDDLEDOCK PLACE PUMP STATION & FORCE MAIN

BLAND DISTRICT - PRINCE GEORGE COUNTY - VIRGINIA

FORCE MAIN PLAN & PROFILE

JOB NO.
27768

SHEET NO.
C1.1

These plans and associated documents are the exclusive property of TIMMONS GROUP and may not be reproduced in whole or in part and shall not be used for any purpose whatsoever, inclusive, but not limited to construction, bidding, and/or construction staking without the express written consent of TIMMONS GROUP.

PRINCE GEORGE COUNTY
DEPARTMENT OF PUBLIC UTILITIES

NOTES:

- ALL MATERIALS FOR SEWER AND WATER SYSTEMS SHOWN SHALL BE SUPPLIED AND INSTALLED IN ACCORDANCE WITH THE LATEST SPECIFICATIONS OF PRINCE GEORGE COUNTY APPLICABLE AT THE TIME OF NOTICE TO PROCEED.
- FOR SEWER AND WATER INSTALLATION WITHIN EXISTING VDOT R/W, UTILITY CONTRACTORS MUST NOTIFY VDOT WHEN INSTALLATION BEGINS SO THAT DENSITY CAN BE TESTED ON TRENCH BACKFILL (95% ASTM. D-698 @ OPTIMUM MOISTURE ± 2%).
- THE INSTALLATION OF A SEWER BACKFLOW DEVICE IS REQUIRED FOR ALL SERVICE CONNECTIONS WHERE THE FINISHED FLOOR ELEVATION IS LOWER THAN THE NEAREST DOWNGRADE AND/OR UPGRADE MANHOLE TOP ELEVATIONS. THIS DEVICE WILL BE INSPECTED BY THE BUILDING INSPECTION DEPARTMENT.
- ALL WATER SERVICE CONNECTIONS BELOW THE ELEVATION CONTOUR OR WHERE THE PRESSURE IS GREATER THAN 80 P.S.I. WILL REQUIRE INDIVIDUAL PRESSURE REGULATORS AS REQUIRED BY BOCA CODE.
- VERTICAL DATUM IS BASED ON MEAN SEA LEVEL (USC & GS DATUM). HORIZONTAL CONTROLS ARE BASED ON VIRGINIA STATE PLANE COORDINATE GRID, SOUTH ZONE, NORTH AMERICAN DATUM OF 1983 (NAD 83).
- CONTRACTOR SHALL PROPERLY NOTIFY ALL PROPERTY OWNERS TWO (2) WEEKS PRIOR TO THE START OF ANY CONSTRUCTION (INCLUDING LAND CLEARING). NOTIFICATION SHALL BE IN THE FORM OF A LETTER SIMILAR TO THE "SAMPLE" REFLECTED IN THE COUNTY'S LATEST WATER AND SEWER SPECIFICATIONS (NOT-1).

REQUIRED INFORMATION FOR TITLE PAGE

APPLICANTS NAME _____
ZONING AND CASE# _____
NUMBER OF LOTS _____
TAX MAP NUMBER _____
DATE OF PLANNING _____
COMMISSION APPROVAL _____

DATE JAN. 2008	STANDARD SEWER AND WATER NOTES	DRWG. NO. DES-2
REVISIONS		

PRINCE GEORGE COUNTY
DEPARTMENT OF PUBLIC UTILITIES

NOTES CONT:

- THE ENGINEER WILL CERTIFY THAT THE ROADS ARE WITHIN 6-INCHES OF SUBGRADE BEFORE WATERLINE CONSTRUCTION CAN BEGIN.
- FOR SEWER AND WATER INSTALLATION WITHIN EXISTING VDOT R/W, UTILITY CONTRACTORS SHALL NOTIFY VDOT 48 HOURS IN ADVANCE WHEN INSTALLATION BEGINS SO THAT DENSITY CAN BE TESTED (95% @ OPTIMUM MOISTURE ± 2%).
- CONTRACTOR SHALL VERIFY LOCATION AND ELEVATION OF ALL UNDERGROUND UTILITIES SHOWN ON THE PLANS IN AREAS OF CONSTRUCTION PRIOR TO STARTING THE WORK. CONTACT ENGINEER IMMEDIATELY IF LOCATION OR ELEVATION IS DIFFERENT FROM THAT SHOWN ON THE PLAN, OR IF THERE APPEARS TO BE A CONFLICT, AND UPON DISCOVERY OF ANY UTILITY NOT SHOWN ON THE PLAN CALL MISS UTILITY OF VIRGINIA AT 1-800-552-7001 (TOLL FREE).
- THE INSTALLATION OF A BACKFLOW DEVICE IS REQUIRED IN ALL HOUSES WHERE THE FINISHED FLOOR ELEVATION IS LOWER THAN THE TOP UPGRADE MANHOLE. THIS DEVICE WILL BE INSPECTED BY THE COUNTY BUILDING INSPECTOR.
- INDIVIDUAL WATER SERVICES SHALL BE 3/4"
- ALL WATERLINE VALVES MUST BE LOCATED ON THE TEE OR CROSS WHEN APPLICABLE.
- ALL MANHOLES IN UTILITY EASEMENTS ARE TO HAVE THE CONCRETE SECTION EXTENDED ONE FOOT ABOVE THE GROUND OR DETAIL MAN-2B SHALL BE USED
- A SMOOTH TRANSITION OF A DROP MANHOLE MUST BE PROVIDED FOR EACH LATERAL OR SANITARY SEWER ENTERING A SANITARY MANHOLE
- ALL FIRE HYDRANTS SHALL BE O.S.H.A. RED IN COLOR.
- METER BOXES PROVIDED SHALL BE CAST IRON 12"x18"x24" HIGH WITH CAST IRON LIDS. THE METER ASSEMBLIES ARE TO BE SUPPLIED WITH NEPTUNE PROREAD ENCODERS AND R9001 PIT MIU (REF) ATTACHED TO THE LID. METERS ARE TO BE COMPATIBLE WITH THE PROREAD SYSTEM. A WAND TYPE VISUAL READER COMPATIBLE WITH THE PROREAD SYSTEM WILL BE SUPPLIED TO THE UTILITY DEPARTMENT WITH THE WATER METERS.
- ALL SANITARY SEWER LATERALS THAT ARE INSTALLED OUTSIDE OF THE R/W ARE TO HAVE THE CLEANOUT INSTALLED AT THE EDGE OF THE EASEMENT. A CARBONITE MARKER SHALL ALSO BE INSTALLED TO INDICATE THEIR LOCATION.
- ALL HYDRANTS AND BENDS SHALL BE EQUIPPED WITH MEGA LUGS, KICKERS AND THRUST BLOCKS.
- PRESSURE REDUCING VALVES SHALL BE USED ON LOTS WHERE THE STATIC PRESSURE IN THE SYSTEM EXCEEDS 80 PSI OR AS REQUIRED BY BUILDING CODE.
- CLEANOUTS ARE TO BE INSTALLED ON ALL SANITARY LATERALS IN ACCORDANCE WITH PRINCE GEORGE COUNTY SPECIFICATIONS. THESE CLEANOUTS SHOULD BE INSTALLED AT THE EDGE OF THE R/W.

DATE JAN. 2008	STANDARD SEWER AND WATER NOTES	DRWG. NO. DES-2
REVISIONS		SHEET 2 OF 3

PRINCE GEORGE COUNTY
DEPARTMENT OF PUBLIC UTILITIES

NOTES CONT:

- UTILITY INSPECTOR SHALL BE CONTACTED BEFORE INDIVIDUAL SERVICE CONNECTIONS ARE COVERED.
- ALL MANHOLES WITHIN 1,000 FEET OF A FORCE MAIN DISCHARGE SHALL BE COATED AS REQUIRED IN THE LATEST COUNTY SPECIFICATIONS.
- ALL INDIVIDUAL WATER AND SEWER CONNECTIONS SHALL BE MADE USING DOUBLE BANDED, STAINLESS STEEL, EPOXY COATED SADDLES.
- A 'W' AND 'S' SHALL BE STAMPED IN THE CURB WHILE THE CONCRETE IS STILL WET. THESE MARKS SHALL INDICATE THE ACTUAL LOCATION OF THE WATER AND SEWER CONNECTIONS FOR EACH LOT.
- ALL MANHOLES SHALL BE SEALED AT THE JOINTS WITH AN EXTERNAL RUBBER SLEEVE SIMILAR TO THE INF1-SHIELD SEAL WRAP AS MANUFACTURED BY SEALING SYSTEMS, INC. THE SEAL SHALL BE MADE OF EPDM (ETHYLENE PROPYLENE DIENE MONOMER) RUBBER WITH A MINIMUM THICKNESS OF 65 MILS. EACH UNIT SHALL HAVE A 2-INCH WIDE MASTIC STRIP ON THE TOP AND BOTTOM EDGE OF THE RUBBER WRAP. THE MASTIC SHALL BE NON-HARDENING BUTYL RUBBER SEALANT, WITH A MINIMUM THICKNESS OF 125 MILS.
- THE BOXES FOR THE SEWER CONNECTIONS MUST BE MARKED AS SEWER CONNECTIONS RATHER THAN WATER METER.
- ALL GATE VALVE BOXES LOCATED OUTSIDE THE PAVEMENT NEED TO BE ENCLOSED IN A 12"x12"x6" CONCRETE ENCLOSURE.

DATE JAN. 2008	STANDARD SEWER AND WATER NOTES	DRWG. NO. DES-2
REVISIONS		SHEET 3 OF 3

PRINCE GEORGE COUNTY
DEPARTMENT OF PUBLIC UTILITIES

PLAN

SECTION

NOTE: VENT SHALL BE AS SEW-3.

DATE JAN. 2008	FORCE MAIN DISCHARGE	DRWG. NO. SEW-6
REVISIONS		